

INFINITY

BATHWARE

Taymor



AVAILABLE FINISHES

OIL RUBBED BRONZE
US10B



SATIN NICKEL
US15



POLISHED CHROME
US26



FEATURES

- CONCEALED SURFACE MOUNT
- LIFETIME WARRANTY
- MOUNTING HARDWARE AND INSTALLATION INSTRUCTIONS INCLUDED



INFINITY

BATHWARE

CONSTRUCTION: ZAMAC (DIECAST ZINC ALLOY)

INCLUDES MOUNTING PLATES — 1⁹/₁₆" (46mm) x 1¹/₁₆" (30mm); NYLON ANCHORS AND STEEL PHILLIPS HEAD SCREWS — #8 x 1¹/₄" (32mm)

		TOWEL BAR TUBE SIZE	TOWEL BAR TUBE MATERIAL	TOWEL RING TUBE MATERIAL	STANDARD PAPER HOLDER ROLLER MATERIAL	PAPER HOLDER/ TOWEL HOLDER MATERIAL
US10B	OIL RUBBED BRONZE	3/4" (19mm)	ALUMINUM	ALUMINUM	PLASTIC	STEEL
US15	SATIN NICKEL	3/4" (19mm)	ALUMINUM	ALUMINUM	PLASTIC	STEEL
US26	POLISHED CHROME	3/4" (19mm)	ALUMINUM	ALUMINUM	PLASTIC	STEEL

TOWEL BAR

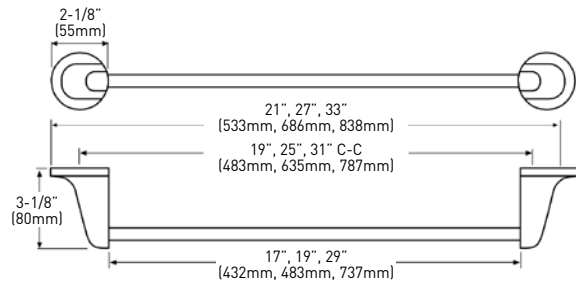

DOUBLE ROBE HOOK

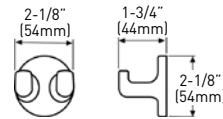

TOWEL RING

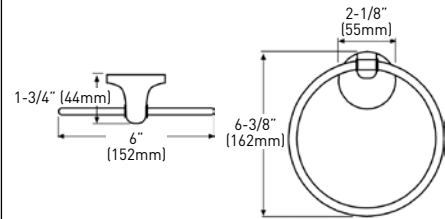

TOOTHBRUSH & TUMBLER HOLDER

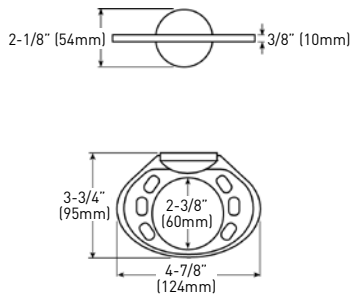

PAPER/TOWEL HOLDER

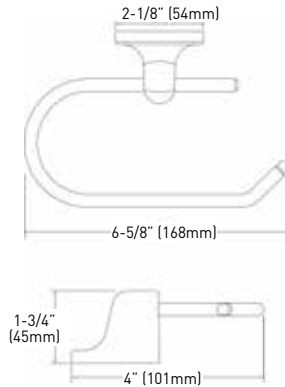

STANDARD PAPER HOLDER

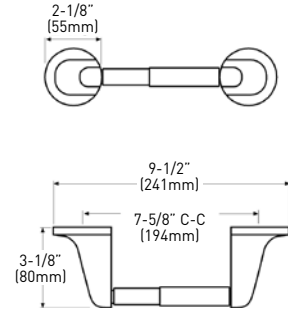

MEASUREMENTS SUBJECT TO A 3% VARIANCE.

PHOTO	DESCRIPTION	OIL RUBBED BRONZE US10B	SATIN NICKEL US15	POLISHED CHROME US26	CASE PACK
	18" x 3/4" TOWEL BAR 24" x 3/4" TOWEL BAR 30" x 3/4" TOWEL BAR	04-BRN8418 04-BRN8424 04-BRN8430	04-SN8418 04-SN8424 04-SN8430	04-8418 04-8424 04-8430	10 10 10
	DOUBLE ROBE HOOK	04-BRN8402	04-SN8402	04-8402	10
	TOWEL RING	04-BRN8404	04-SN8404	04-8404	10
	PAPER/TOWEL HOLDER	04-BRN8448	04-SN8448	04-8448	10
	STANDARD PAPER HOLDER	04-BRN8408	04-SN8408	04-8408	10